

INTELDIM120: Programming Instructions



Overview

- This bluetooth dimmer can be operated manually or via the Smart Life App.

Features

- Compatible with LED, Halogen, Incandescent.
- Compatible with 1 Gang Median Front plates.
- Min. back box depth 25mm.
- Does not require a neutral at switch.

Note

Scene and scheduling menus in the Smart Life app are not compatible with this Bluetooth device

Dimensions

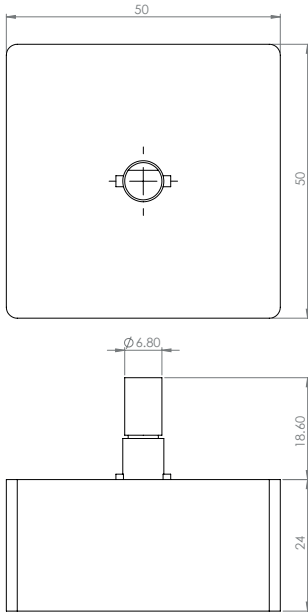

Specifications

Operating Voltage	220-240V
Frequency	50Hz
LED Lamps	10-120W (max. 10 Lamps)
Incandescent/Halogen	10-200W
Dimming Mode	Trailing Edge
Control Method	1 Way
Alexa/Google Assist Compatibility	No
Standards	BS EN55015, BS EN60669-2-1

Wiring Diagrams

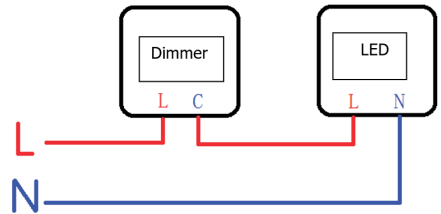

INTELDIM120: Programming Instructions

This switch is not suitable for

- Fluorescent lamps and tubes
- Wire-wound or toroidal transformers
- CFL lamps

Fitting your dimmer switch

Incorrect installation may damage the dimmer beyond repair.

In case of any doubt or difficulty consult a qualified electrician.

Factory Reset - Required upon installation of dimmer or replacement of new lights.

•When installation is complete press knob to ensure dimmer is off, then press and hold for 5 seconds to complete factory reset.



SMARTLIFE APP DOWNLOAD

Using Dimmer with Smart Life App (Ensure Bluetooth is enabled)

1. Download App using QR code.
2. Open App.
3. Create Smart Life Account.
4. Go to App.
5. Press '+' symbol or 'Add Device', App will search for device. (ensure proximity to device as close as possible when pairing).
6. If device is not discovered immediately then push dimmer knob 'ON', press and hold for 5 secs to enter pairing mode.
7. When device is discovered Tap 'Add', wait whilst device is added, and press 'Done' when added successfully.
8. Edit device details as applicable.
9. Tap device image to enable dimming interface.
Device can be controlled via the dimming interface and/or manually operating the dimmer knob.

Channel 1 control Options

1. Below Total Control brightness bar tap on Channel1 (Dimmer1) to access options:
 - a. Power (Turn dimmer on/off).
 - b. Schedule (not compatible with this device).
 - c. Timer (Countdown function).
 - d. Setting (Set brightness range of dimmer).

Setting brightness range of dimmer

The maximum and minimum brightness range of the dimmer will vary according to installation and actual load.
Recommendations:

- Minimum brightness not to be set below 3%
- Maximum brightness not to be set above 80%

Suggested Ranges for optimal performance:

- Min. 5% - 75% Max.
- Min. 3% - 55% Max.

After setting the desired range, save using the editable padlock icon in the lower left-hand corner and exit.

At this point all parameters are configured and can be used normally.